

A

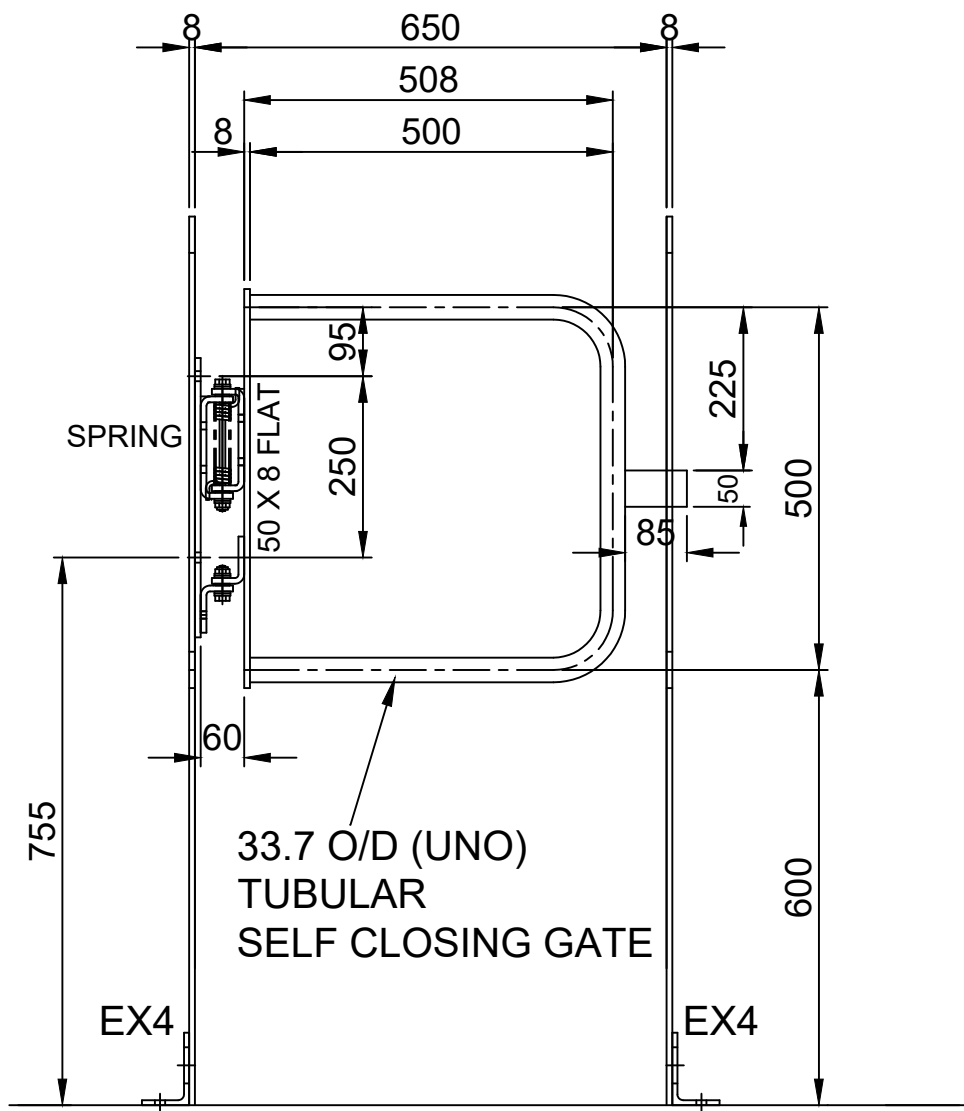

TUBULAR GATES
TOTAL No REQ
(SUITS BOTH HANDS)

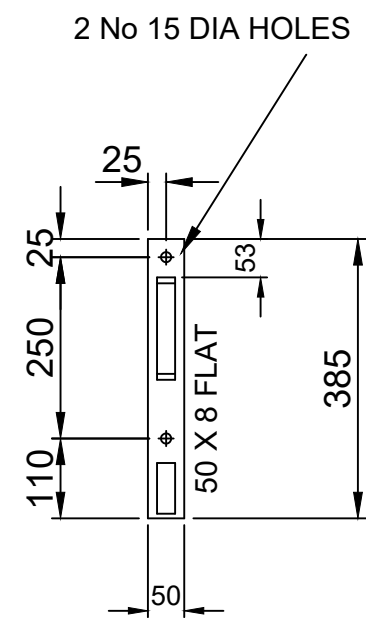
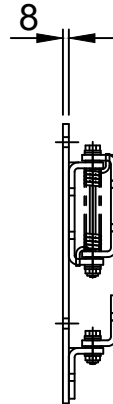
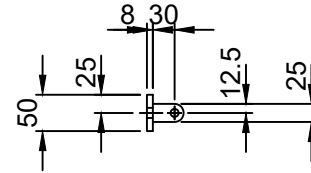

GATE BRACKET
TOTAL No REQ

500 GATES
FOR EX4

ALL ITEMS TO BE HARD STAMPED.
ALL WELDS 6mm LEG FILLET WELDS U.N.O

Manufactured in accordance with BS EN ISO 1090
Parts 1 & 2.. Execution class 2

FOR WELD PROCEDURE SPECIFICATIONS
REFER TO DRAWING WPS-SK02 Gate Weld Details

MATERIALS (UNO)	CHS - S235JR FLATS - S275JR SPRING & FITTINGS - GR304 ST / ST
FINISH	GALVANISED (UNO)

TITLE:
STANDARD DRAWING FOR
EX LADDER HALF HEIGHT GATE - 500 to EX4

Customer: GA Ref:

Drawn: MDG Date: FEB 2022 Scale:

Drawing Number: EX - H.H.Gate - 500 to EX4

Amendment					
-----------	--	--	--	--	--

GUARDRAIL
Engineering
Manders Industrial Estate
Old Heath Road
Wolverhampton WV1 2RP