

Guardrail

ENGINEERING LTD.



AXESS EUROPE LADDER SYSTEM



AXESS EUROPE Vertical Ladder System:

Guardrail's "AXESS EUROPE" vertical permanent ladder system is a safe, simple modular design offering individual parts which bolt together to form a complete ladder.

Parts are usually kept ex-stock for quick delivery or can be supplied as a complete ladder once the floor to floor dimension is given.

This system tries to eliminate the need for expensive site surveys and the preparation of detail drawings which adds to delivery time.

Enhanced Slip Resistance

Ladder rungs are produced from punched plank pattern type O₂-30 / 30.

The O₂ pattern has surface holes of 9mm diameter punched up and 5mm drainage holes affording both high slip resistance properties and excellent drainage.

Health & Safety

The unique design and production of "AXESS EUROPE" components are generally compatible to BS EN ISO 14122-4:2004+A1:2010 (E).

Ladder sections have been independently tested and they comply with the loading requirements and performance tests as detailed in BS EN 131-2:2010+A1:2012.

It is recommended that operatives using vertical ladders wear protective gloves.

Flexible

"AXESS EUROPE" is usually available "off the shelf" and is so flexible it will solve virtually any access problem.

Easy to install

"AXESS EUROPE" is straightforward to install.

Supplied in "flat pack" form for ease of transportation.



Manufactured in accordance
with EN1090 Parts 1 & 2
Execution Class 2

Quality Assured to EN 9001



System Components:

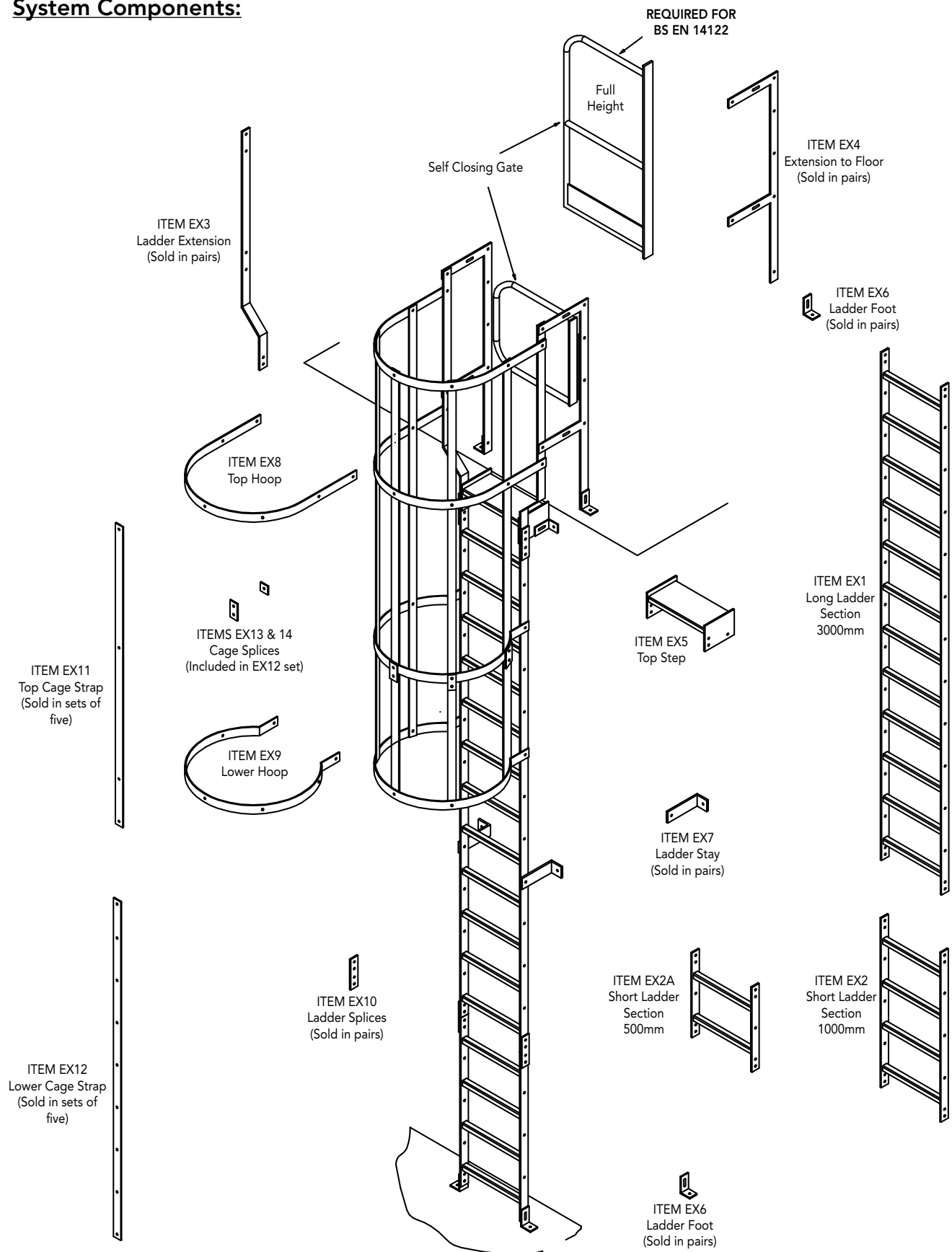

Ladder Assembly Detail:

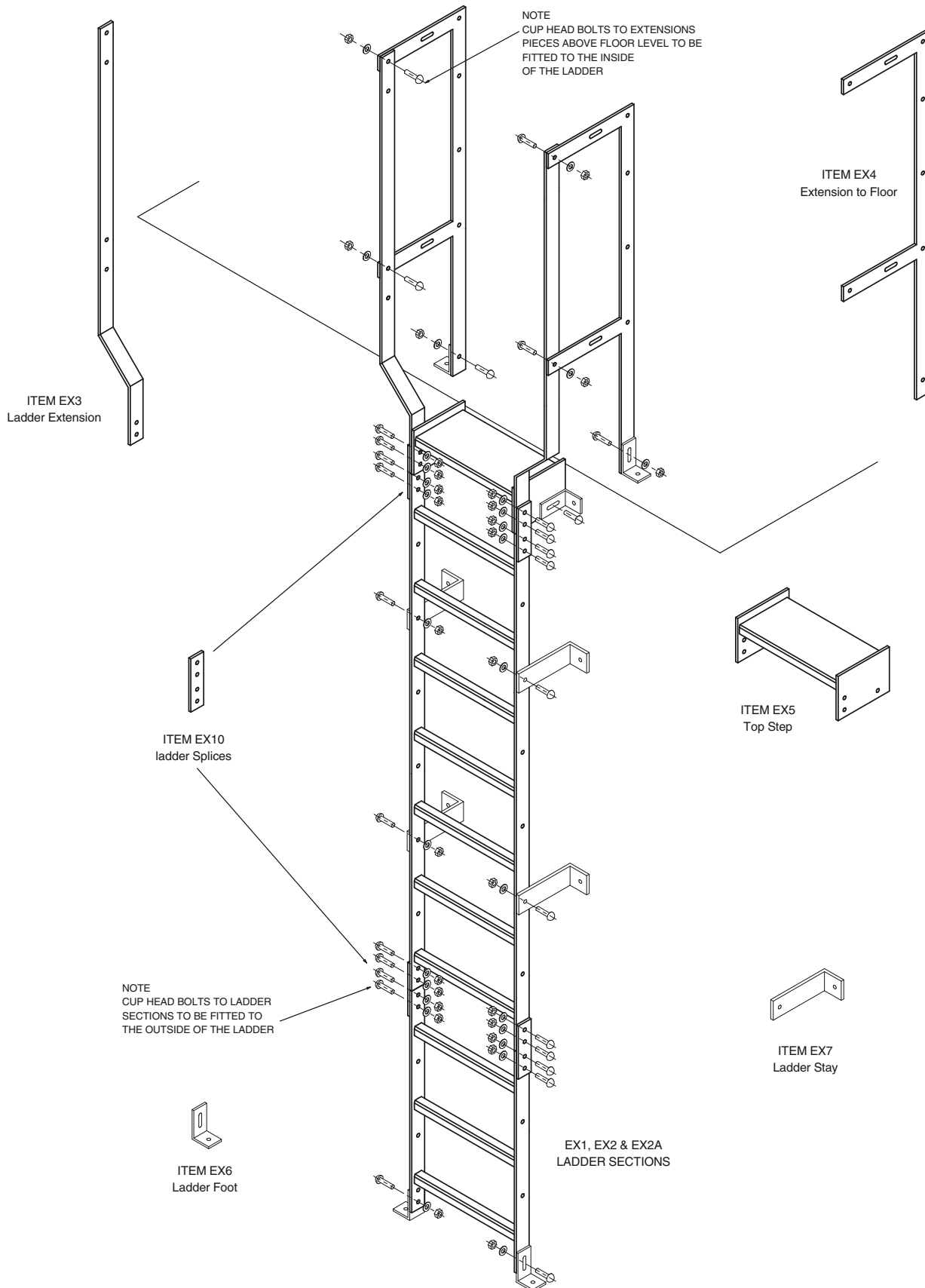

Cage Assembly Detail:

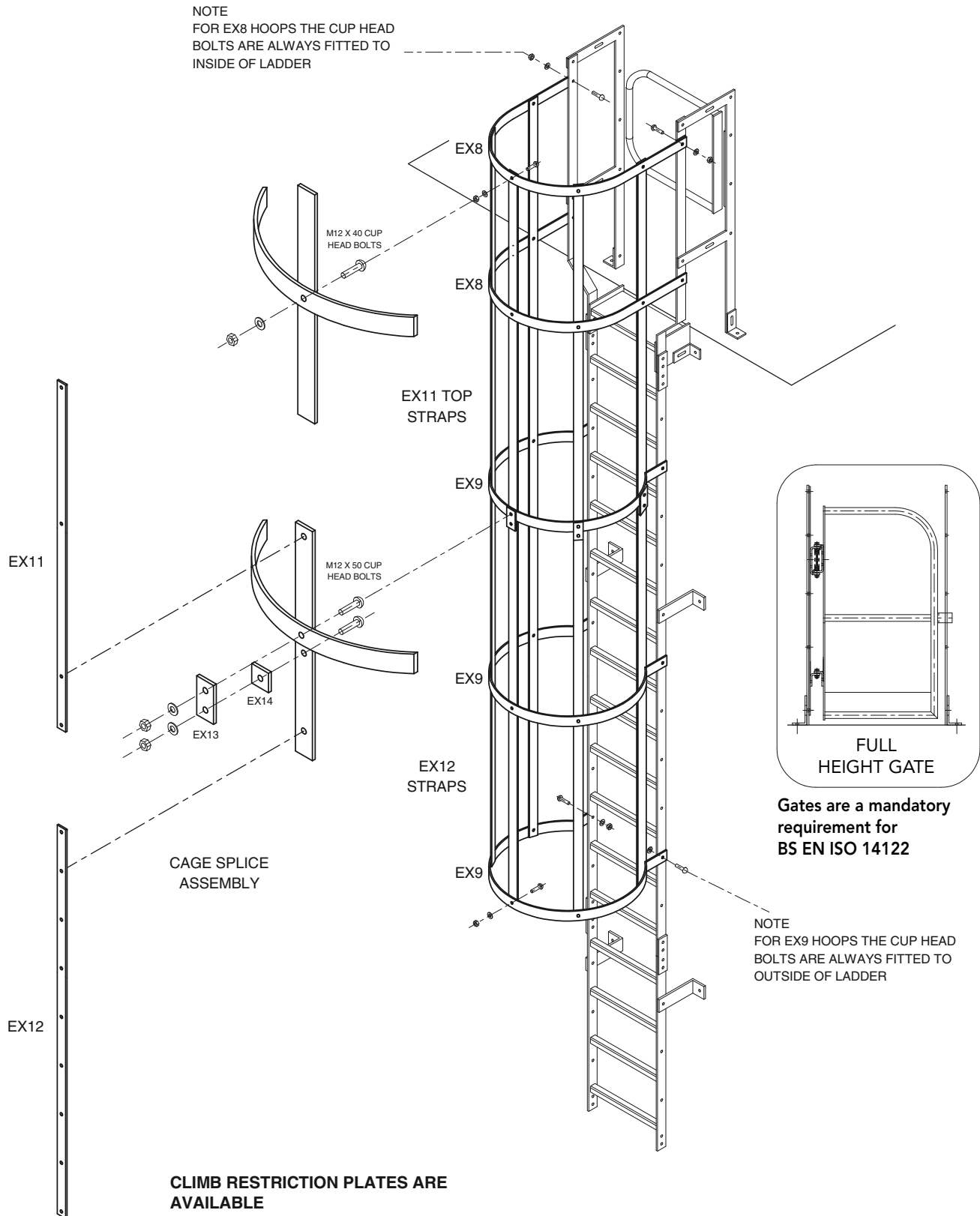

Typical examples - for approx 2000, 2500 or 3000 mm rises:

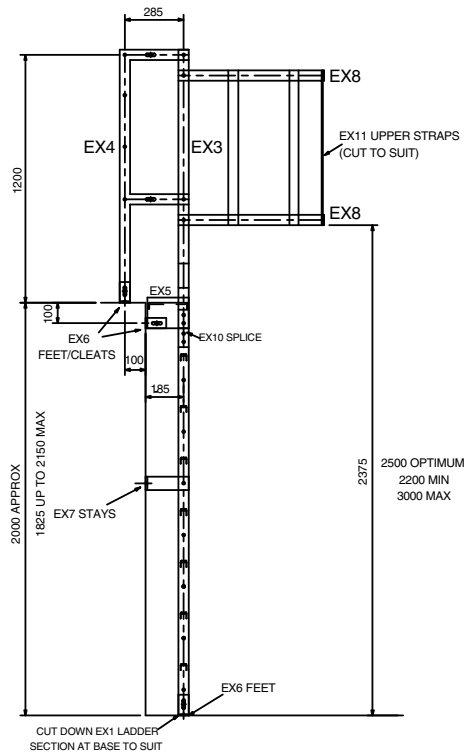

TYPICAL EXAMPLE FOR APPROX 2000 RISE
(1825 TO 2150 mm) **MODEL EX2000**

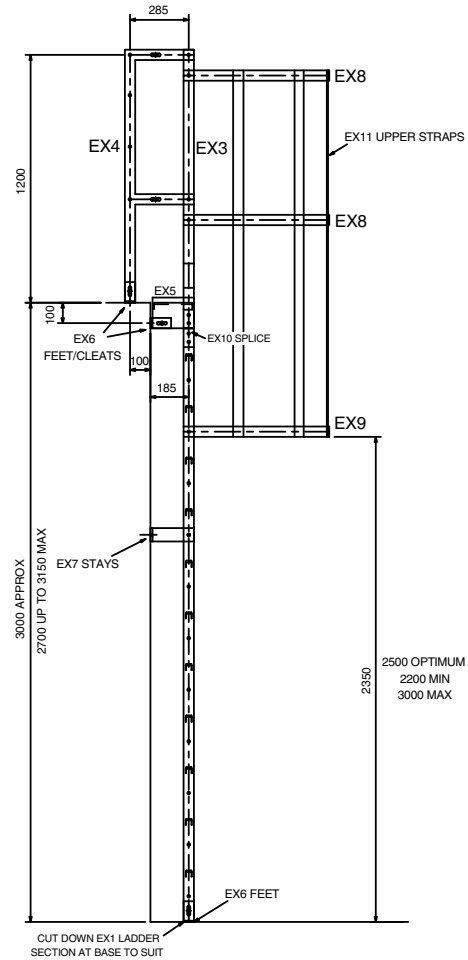

TYPICAL EXAMPLE FOR APPROX 3000 RISE
(2700 TO 3150 mm) **MODEL EX3000**

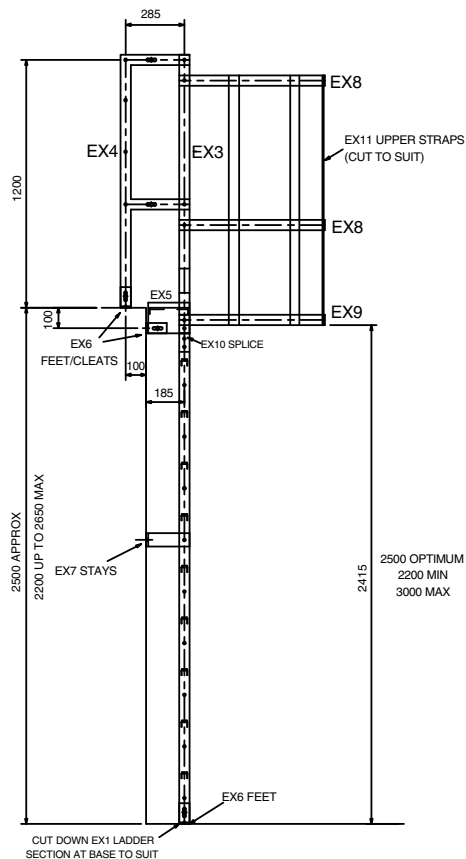

TYPICAL EXAMPLE FOR APPROX 2500 RISE
(2200 TO 2650 mm) **MODEL EX2500**



Self Assembly Ladder System

Typical examples - for approx 3500 & 4000 mm rises:

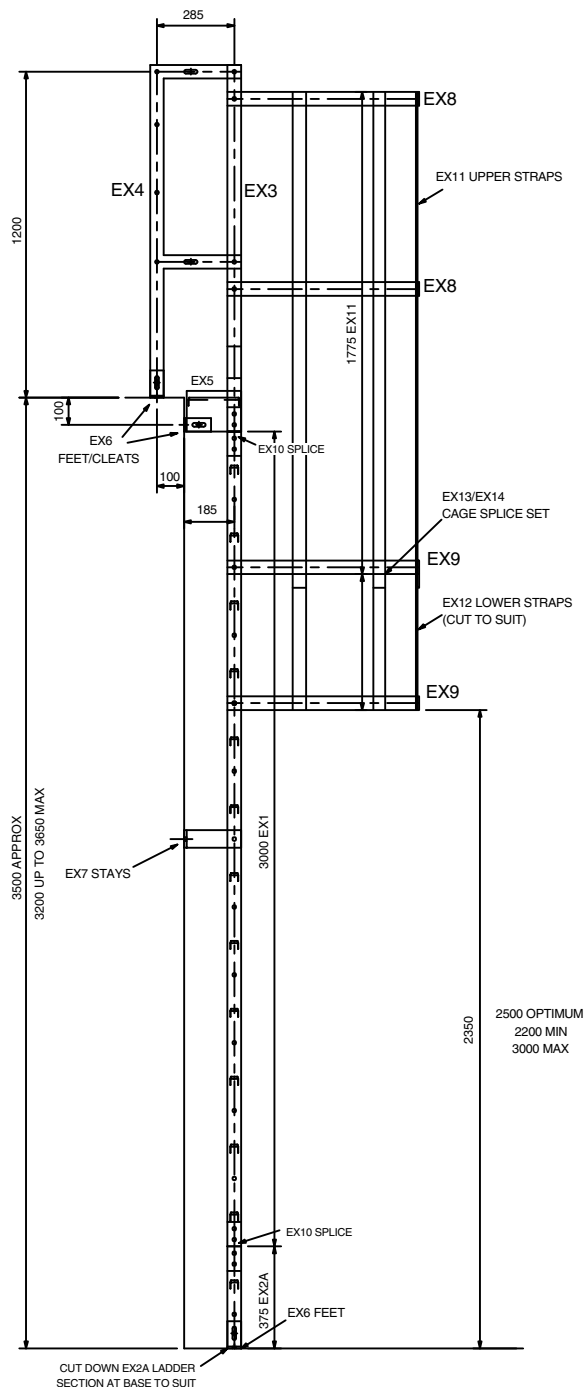

TYPICAL EXAMPLE FOR APPROX 3500 RISE
(3200 TO 3650 mm) **MODEL EX3500**

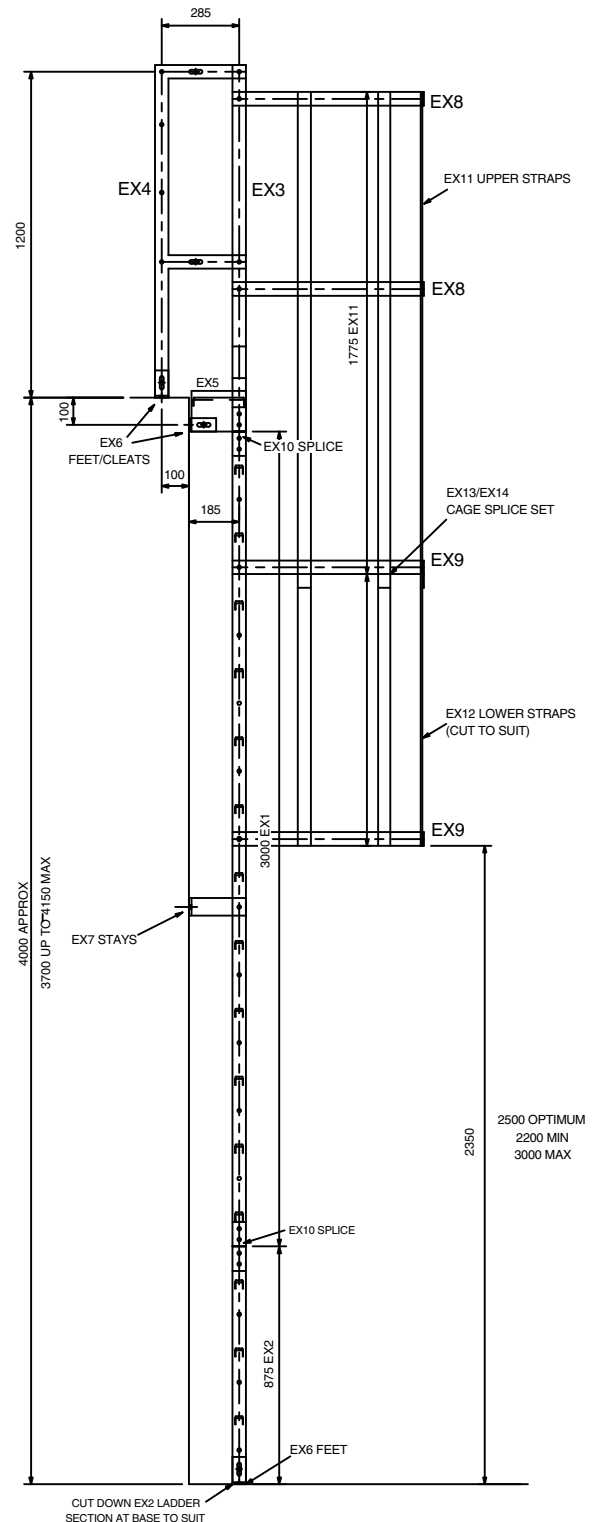

TYPICAL EXAMPLE FOR APPROX 4000 RISE
(3700 TO 4150 mm) **MODEL EX4000**

Typical examples - for approx 4500 & 5000 mm rises:

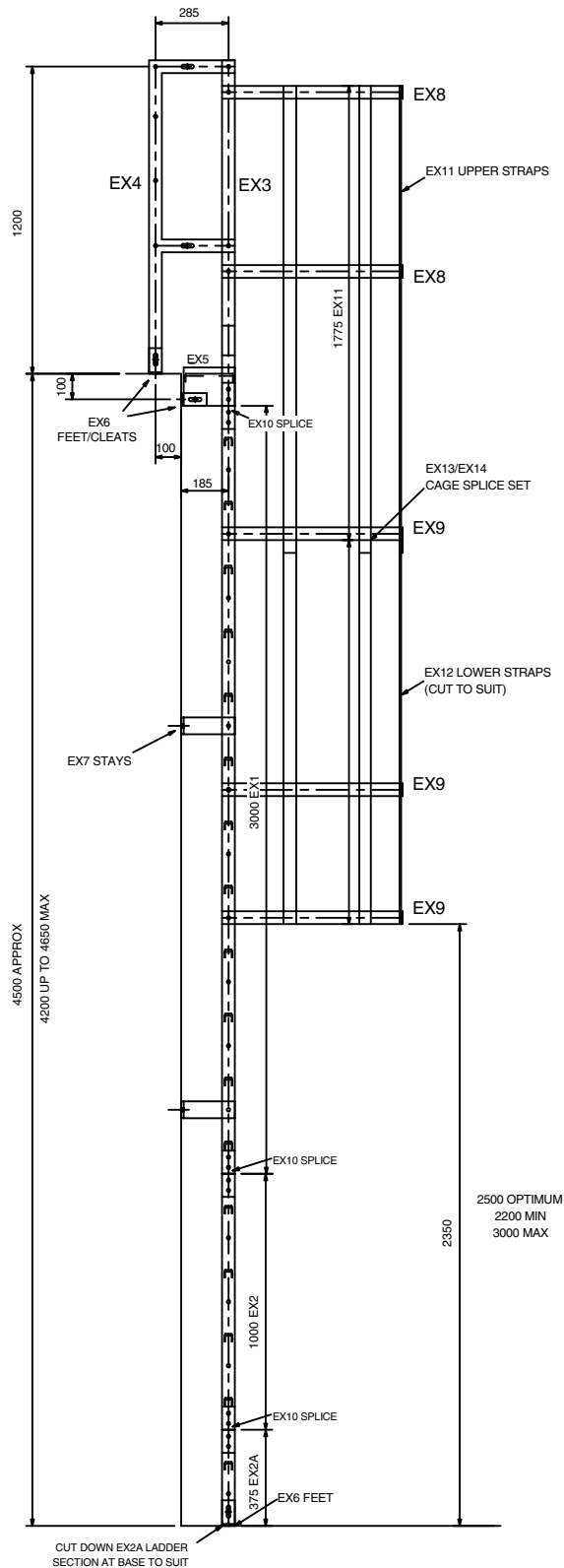

TYPICAL EXAMPLE FOR APPROX 4500 RISE
(4200 TO 4650 mm) **MODEL EX4500**

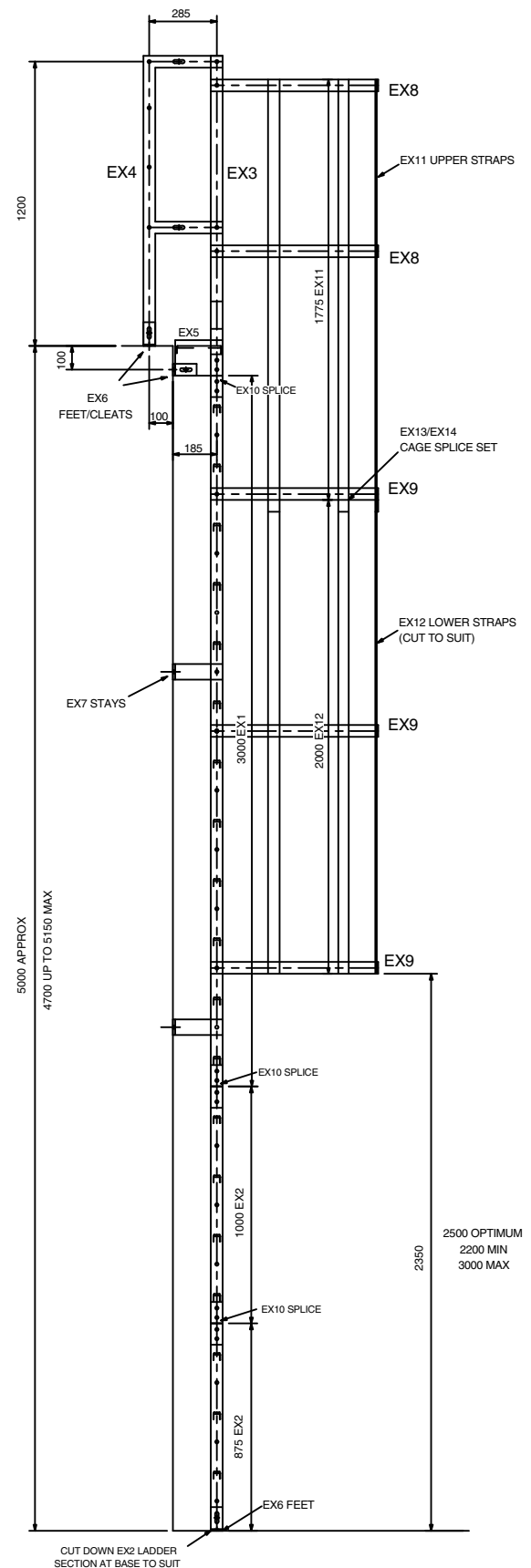

TYPICAL EXAMPLE FOR APPROX 5000 RISE
(4700 TO 5150 mm) **MODEL EX5000**

Typical examples - for approx 5500 & 6000 mm rises:

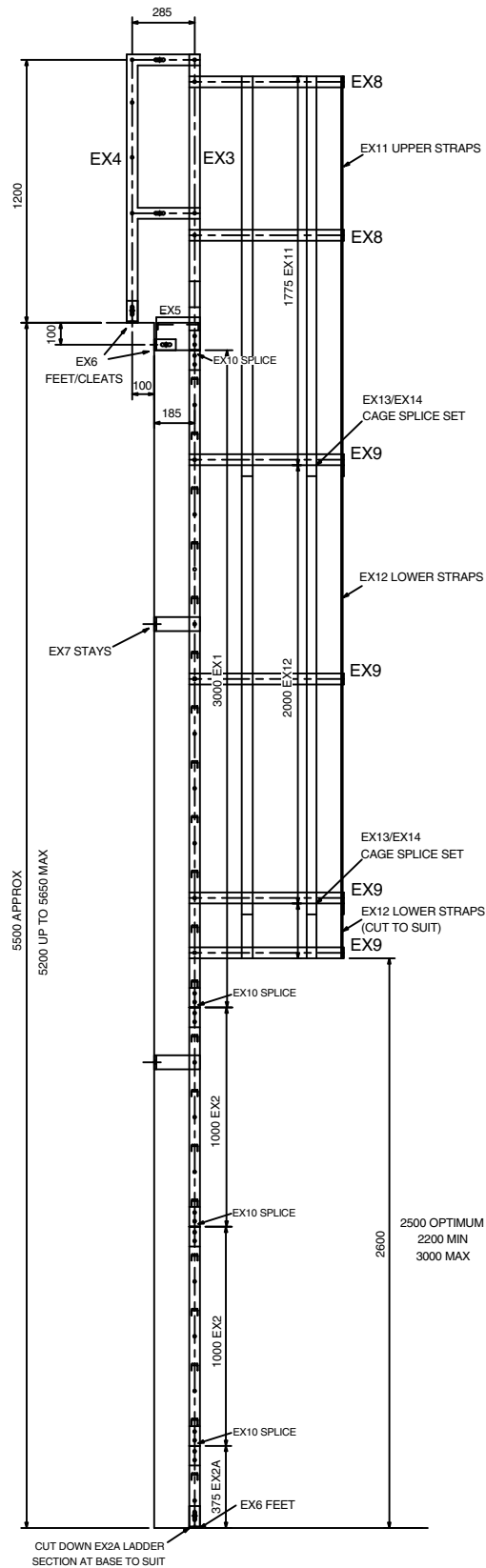

TYPICAL EXAMPLE FOR APPROX 5500 RISE
(5200 TO 5650 mm) **MODEL EX5500**

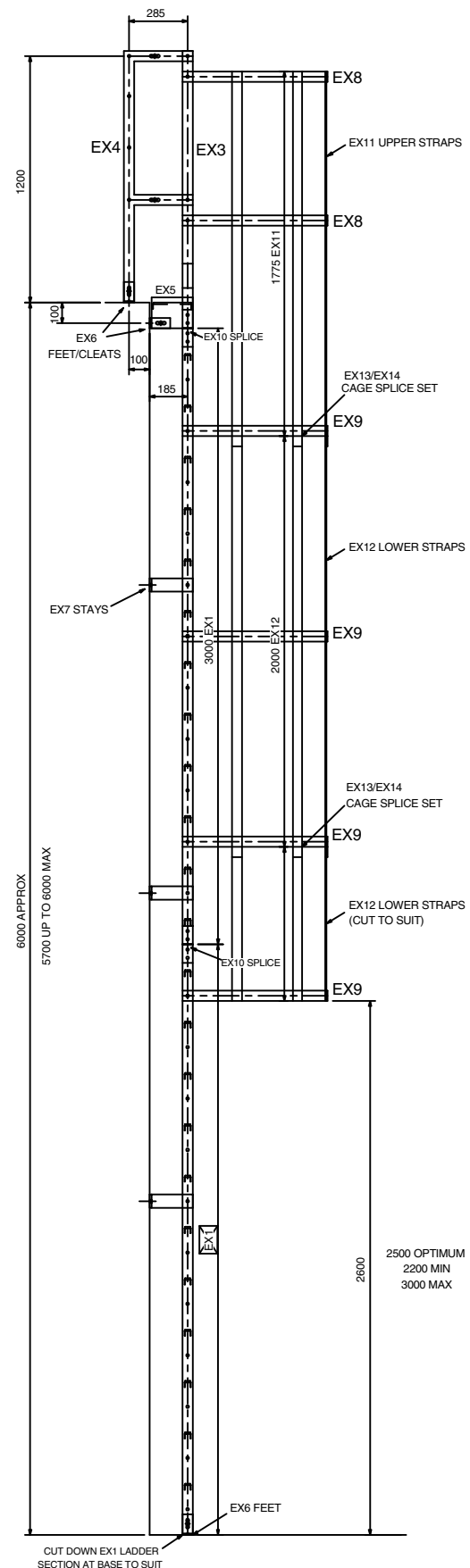

TYPICAL EXAMPLE FOR APPROX 6000 RISE
(5700 TO 6000 MAX) **MODEL EX6000**



Guardrail



Member of PF Group

Guardrail Engineering Limited · Manders Industrial Estate · Old Heath Road · Wolverhampton WV1 2RP
Phone: 01902 871208 · Fax: 01902 453330
enquiries@guardrailgroup.com · www.guardrailgroup.com